

INSTA-LOC™ SERIES  
PUSH-FIT SYSTEM

 **LEGEND VALVE**

Cut. Prep. Push.™  
It's that simple.

**Guaranteed.**



 **INSTA-LOC™**



## Insta-Loc™ Advantages



Insta-Loc™ Tee featuring PEX, CPVC and Copper tubing

Introducing Legend's Insta-Loc™ push-fit valves and fittings. Insta-Loc™ is engineered for connection to copper, CPVC, and Pex tubing in seconds. Insta-Loc™ provides a clean and easy joining method that's designed to save time and money on installations. Installing a joint with Insta-Loc™ is the best alternative to solder, glue, or crimping for a permanent connection designed to last a lifetime.

Insta-Loc™ valves and fittings are manufactured from an ASTM forged brass alloy making them lighter and stronger than traditional cast bronze construction. They are also 100% pressure tested. The result is higher quality and greater reliability.

### Safe: No Flames

The Insta-Loc™ push fit system means the elimination of flames and noxious by-products. No flames means no more concerns about fire on the jobsite and no more heat damaged valves.

### Fast: Installation Time is Dramatically Reduced

Insta-Loc™ decreases the amount of time to complete a connection by a minimum of 60% versus soldering a copper fitting. Valves and fittings can be installed on wet or dry piping systems, installed effortlessly, and can be tested immediately.

### Simple: Cut, Prep, and Push!

Insta-Loc™ is simple requiring no additional materials beyond the fitting or valve for permanent connection to copper or CPVC. PEX installations require the addition of a brass insert.

### Value: Reduces Labor and Eliminates Material

Insta-Loc™ reduces the cost of materials (solder, flux, and torch fuel), insurance cost, (due to hot work permits) and time required on-site for adhesive curing and system flushing.

### Quality: 100% Pressure Tested

Insta-Loc™ quality assures a positive and permanent connection. Each valve and fitting is manufactured to strict tolerances and individually pressure tested to ensure 100% reliability.

### Guaranteed:

A great product deserves a great guarantee that's why we offer the best in the industry, "5 years and \$25 dollars back".





**Insta-Loc™ works with the following tubing systems:**

- 1. Copper: K,L & M hard-drawn copper tube meeting ASTM B88
- 2. CPVC D2846 CTS size
- 3. PEX: A, B, and C meeting ASTM F876 & F877

Not suitable for use on PEX tubing with an oxygen barrier on the outer layer or composite PEX-AL-PEX tubing.

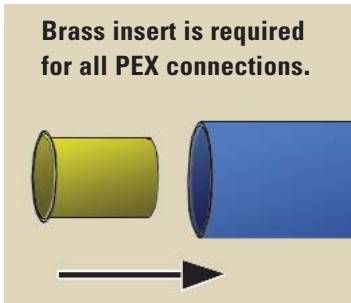

**How it works**

The following installation instructions are identical for all tubing types. For PEX tubing, a brass insert is required. The brass insert has been designed by Legend for use with Insta-Loc™ valves and fittings.

**3 Step Permanent Connection**

**Step 1: Cut**

Tube must be cut on a 90 degree angle, round, and free of deep scratches.

**Step 2: Prep**

\*Deburr tube and inspect to ensure that all burrs and ridges are removed. Mark tube 1-1/4" from the end of the tube. Apply thin layer of lubricant suitable for use on potable water.

**Step 3: Push**

Insert tubing into Insta-loc™ up to the mark while preventing lateral movement of the pipe.

**Cut, Prep, and Push!**

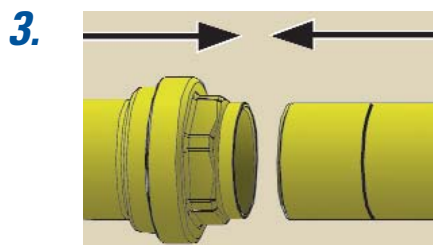
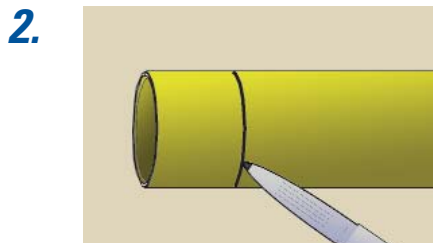
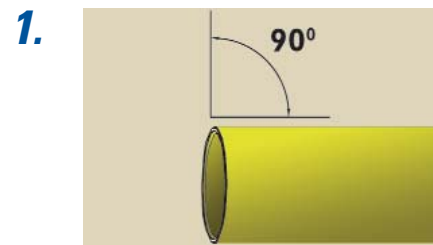

\*Failure to follow proper installation instructions may damage o-ring, voiding the warranty

**Insta-Loc™ T-1200 Full Port Forged Brass Ball Valve** ISO 9002

### Legend Model T-1200

T-1200 ball valves are constructed of heavy duty forged brass. The T-1200 is the industry's only integrated push-fit ball valve design, eliminating possibly leaky seams. They are designed for residential and commercial use on potable water, hydronic heating or compressed air. Their full ports allow for a maximum of flow and a minimum of pressure drop or turbulence. The heavy duty blowout-proof stem utilizes two Dyneon TFM™ PTFE anti-friction washers and two Viton® o-rings.

Part No.	Size	Model
101-123	1/2"	T-1200 Insta-Loc™
101-124	3/4"	T-1200 Insta-Loc™
101-125	1"	T-1200 Insta-Loc™



T-1200

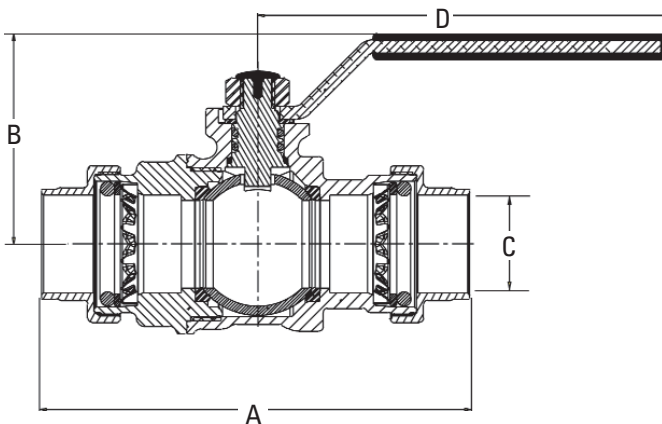

### Insta-Loc™ End Adaptor

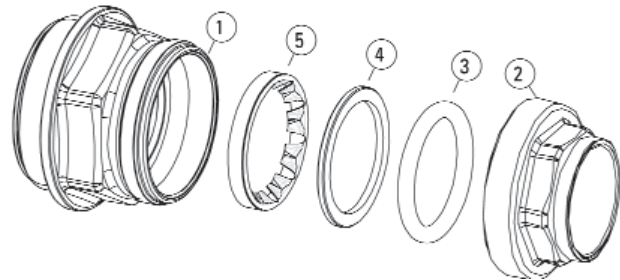

### Dimensions in Inches

Valve Size	A	B	C	D	C.V.**
1/2"	3.08	1.42	.59	3.07	14.9
3/4"	3.90	1.87	.79	3.78	28.8
1"	4.14	2.02	1.00	3.70	56.7

\*\*The CV Factor is the gallons of water per minute passed through the valve with a 1 PSI pressure drop.

### Insta-Loc™ End Adaptor Material Specifications

Part No.	Part	Material
1.	Body	Forged Brass C37700
2.	Retainer Nut	Forged Brass C37700
3.	O-Ring	EPDM
4.	Guide Ring	Brass C37700
5.	Grip Ring	Inox Stainless Steel

### Material Specification

Part	Material
Handle nut	Dacromet® coated steel
Handle	Dacromet® coated steel
Anti-friction washer	Dyneon TFM™ PTFE
Stem O-rings	Viton®
Thrust washer	Dyneon TFM™ PTFE
Stem	Chrome plated forged brass
Ball	Chrome plated forged brass
Seats	Dyneon TFM™ PTFE
Body & end adapter	Forged brass

### Pressure Ratings

1/2"	230 W.O.G. Non-Shock
3/4"	230 W.O.G. Non-Shock
1"	230 W.O.G. Non-Shock @ 230° F

### Valve Seat Ratings

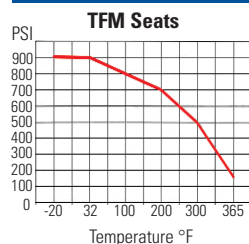

Viton® is a registered trademark of DuPont  
Dyneon TFM™ is a registered trademark of 3M Company



Legend products are recyclable

## Insta-Loc™ 90 Degree Elbow ISO 9002



90° ELBOW

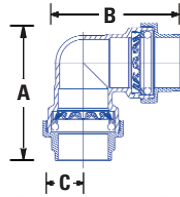

Dimensions

Part No.	Size	Model	A	B	C
455-003	1/2"	Insta-Loc™ 90° Elbow	2.204	2.204	0.590
455-004	3/4"	Insta-Loc™ 90° Elbow	2.449	2.449	0.709

## Insta-Loc™ Coupling ISO 9002



COUPLING

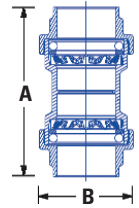

Dimensions

Part No.	Size	Model	A	B
455-503	1/2"	Insta-Loc™ Coupling	2.598	1.181
455-504	3/4"	Insta-Loc™ Coupling	2.598	1.420

## Insta-Loc™ Drop Ear Elbow ISO 9002



DROP EAR ELBOW

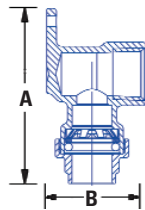

Dimensions

Part No.	Size	Model	A	B
455-150	1/2"	Insta-Loc™ Drop Ear Elbow	2.618	1.594

## Insta-Loc™ FIP Adaptor ISO 9002



FIP ADAPTOR

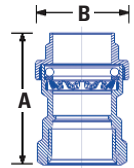

Dimensions

Part No.	Size	Model	A	B
455-703	1/2"	Insta-Loc™ FIP Adaptor	1.988	1.181
455-704	3/4"	Insta-Loc™ FIP Adaptor	2.027	1.420

## Insta-Loc™ Tee ISO 9002



TEE

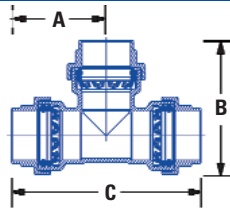

Dimensions

Part No.	Size	Model	A	B	C
455-153	1/2"	Insta-Loc™ Tee	1.624	2.214	3.248
455-154	3/4"	Insta-Loc™ Tee	1.740	3.480	2.449

## Insta-Loc™ MIP Adaptor ISO 9002



MIP ADAPTOR

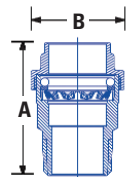

Dimensions

Part No.	Size	Model	A	B
455-753	1/2"	Insta-Loc™ MIP Adaptor	1.909	1.181
455-754	3/4"	Insta-Loc™ MIP Adaptor	2.027	1.420

## Insta-Loc™ Reducing Tee ISO 9002



REDUCING TEE

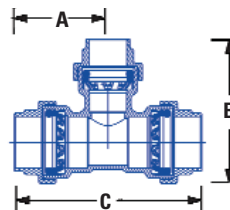

Dimensions

Part No.	Size	Model	A	B	C
455-208	3/4" x 1/2"	Insta-Loc™ Red Tee	1.791	2.215	3.582
455-259	1/2" x 3/4"	Insta-Loc™ Red Tee	1.624	2.499	3.248

## Insta-Loc™ Brass Insert ISO 9002

FOR USE ON PEX TUBING WITH INSTA-LOC™ FITTINGS. ONLY ASTM F877 & F876 PEX PIPE WITH A NON-EXTERNAL OXYGEN BARRIER MAY BE USED IN INSTA-LOC™ FITTINGS.



INSERT

Part No.	Size	Model
455-903	1/2"	Insta-Loc™ Brass Insert
455-904	3/4"	Insta-Loc™ Brass Insert

- **Guaranteed 24 Hour Shipping**
- **Guaranteed 100% Fill Rate**
- **Guaranteed 100% Accuracy**
- **Guaranteed Sale**
- **Guaranteed Products**
- **Guaranteed Performance**

**Downstream  
Thinking.**  
It's all about Performance®



## THE PERFORMANCE SPECIALISTS™



### **A Legendary Guarantee:**

Legend Valve & Fitting warrants each valve manufactured in its ISO-9002 facilities to be free of defects in materials and workmanship for a period of 5 years from the date of purchase when properly installed and operated under normal use and service. Should one of these valves be proven defective, Legend will pay directly to the installing contractor \$25.00 to help offset the cost of replacement in addition to replacing the valve. For complete details of this legendary warranty, please contact us.



Legend Valve & Fitting  
51245 Filomena Drive  
Shelby Township, MI 48315  
1-800-752-2082  
[www.legendvalve.com](http://www.legendvalve.com)

LT-ISB

